

1227800
[0829110H]

TRI-PARTY AGREEMENT

Change Notice Number TPA-CN- 622	TPA CHANGE NOTICE FORM	Date: April 3, 2014
Document Number, Title, and Revision: DOE/RL-2009-124, 200 West Pump and Treat Operations and Maintenance Plan, Revision 2		Date Document Last Issued: November 2013
Originator: Bob Cathel		Phone: 373-9171

Description of Change:
Revision of DOE/RL-2009-124, Appendix B, Waste Management Plan for the 200 West Pump and Treat to allow storage of IDW at a centralized location near B6269 5-Bay area.

Briant Charboneau and Emy Laija agree that the proposed change
DOE **EPA**
modifies an approved workplan/document and will be processed in accordance with the Tri-Party Agreement Action Plan, Section 9.0, *Documentation and Records*, and not Chapter 12.0, *Changes to the Agreement*.

Page B-9, Section B3.3, Waste Storage, is changed by adding Figure B-5 and adding the double underlined text, as follows:

The IDW waste (e.g., drill cuttings) may be accumulated near the point of generation while awaiting analytical laboratory test results. IDW may also be accumulated at the 200-ZP-1/200-PW-1/200-UP-1 consolidated *Comprehensive Environmental Response, Compensation, and Liability Act of 1980 (CERCLA)* waste storage area (Figure B-4). Additionally, IDW may be managed at the centralized CERCLA waste storage area near building 6269 5-Bay (5-Bay area) (Figure B-5). IDW managed at the 5-Bay area may be consolidated, as appropriate, irrespective of operable unit origin, to facilitate efficient waste management practice. If IDW must be stored for longer than 6 months after designation, concurrence from the lead regulatory agency will be obtained on storage, treatment, and disposal options of the waste along with the disposition schedule.

The referenced figure "Figure B-5" is included on the following page.

Justification and Impacts of Change:

This change will allow the aggregation of IDW, namely miscellaneous solid waste (MSW) from well sampling/maintenance activities from different operable units at one centralized storage area, pending its disposal at an approved facility. The basis for this approach is that the MSW stream is consistent regardless of the groundwater operable unit origin, and there are only minor differences in chemical and/or radiological contamination between MSW from different groundwater operable units.

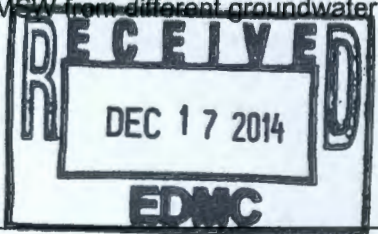

Approvals:			
B.L. Charboneau	<i>[Signature]</i>	4-10-2014	<input checked="" type="checkbox"/> Approved <input type="checkbox"/> Disapproved
DOE Project Manager		Date	
E. Laija	<i>[Signature]</i>	10 Apr 14	<input type="checkbox"/> Approved <input type="checkbox"/> Disapproved
EPA Project Manager		Date	
NA			<input type="checkbox"/> Approved <input type="checkbox"/> Disapproved
Ecology Project Manager		Date	

1223813

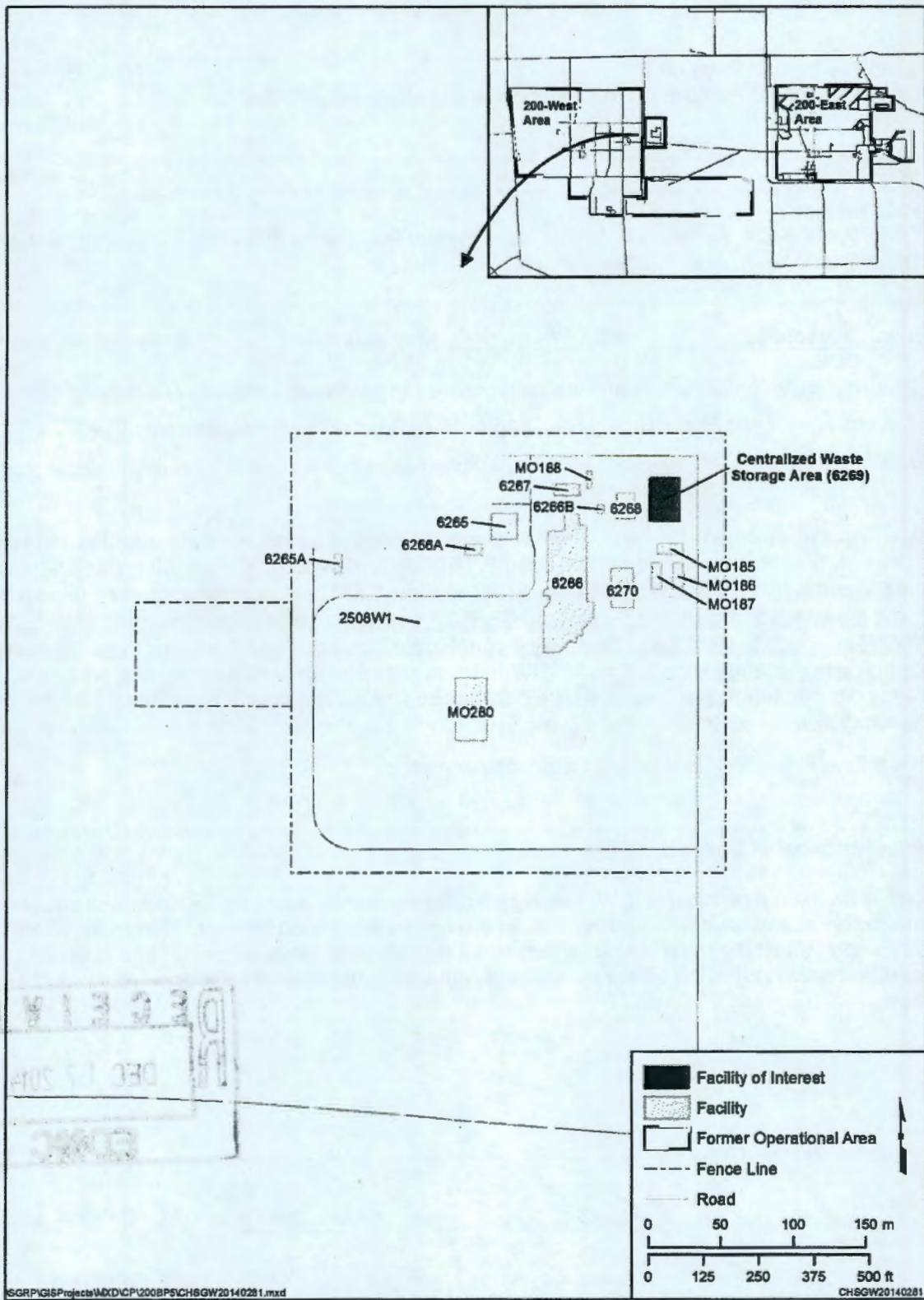

Figure B-5. Centralized Waste Storage Area