

Meeting Minutes Transmittal/Approval
Project Managers' Meeting
200 Area Groundwater and Source Operable Units
1200 Jadwin, Richland, Washington
July 16, 2008

APPROVAL: *Mary Joogd for* Date: 8/21/08
 Larry Romine, 200 Area Unit Manager, DOE/RL

APPROVAL: *Arlene Tortoso* Date: 8/21/08
 Arlene Tortoso, 200 Area ^{PROJECT} Assistant Unit Manager, DOE/RL

APPROVAL: *Craig Cameron* Date: 8/26/08
 Craig Cameron, 200 Area Unit Manager, EPA

APPROVAL: *John Price* Date: 9/2/2008
 John Price, 200 Area Unit Manager, Ecology

HFFACO Action Plan Section 4.1 requires signature of agreements and commitments made during the Unit Manager Meeting. Approval of these minutes documents approval of agreements and commitments documented in Attachment 3 to these minutes. Approval does not apply to any other attachments, which are included in these minutes for informational purposes.

RECEIVED
 SEP 04 2008
 EDMC

Minutes of the 200 Area Project Managers' Meeting of July 16, 2008 are attached.
Minutes are comprised of the following:

Attachment 1	Agenda
Attachment 2	Attendance Record
Attachment 3	Agreements and Issues List
Attachment 4	Action Item List
Attachment 5	Operable Units and Facilities Status
Attachment 6	200-UP-1, Uranium
Attachment 7	200-UP-1, Technetium-99
Attachment 8	Carbon tetrachloride concentrations in extraction well 299-W15-6.
Attachment 9	200-PW-1 OU: 3 Narrow Diameter Vapor Extraction Wells
Attachment 10	Figure 2: Well 299-E33-340 Location Map
Attachment 11	Well 699-52-55 Location Map
Attachment 12	Change Notice for Modifying Approved Documents/Workplans In Accordance with the Tri-Party Agreement Action Plan, Section 9.0, Documentation and Records (TPA-CN-226)

200 AREA PROJECT MANAGERS' MEETING AGENDA

1200 Jadwin/Rm 1-C-1

July 16, 2008

8:30 – 10:00 AM

SOURCE REMEDIES AND D4

- 200-CW-3
- BC Control Area
- 200-UW-1
- Facilities (D4)
- Recap Agreements, Issues and Action Items

GROUNDWATER and SOURCE OPERABLE UNITS

- 200-UP-1, 200-CS-1 and 200-CW-1 Group
- Supplemental Characterization Model Groups 2/4/6 and 5
- 200-BC-1, 200-IS-1, 200-CW-5 and 200-SW-1/2 Group
- 200-ZP-1, 200-PW-1/3/6 Group
- 200-MW-1 Group and 200-PW-2/4
- 200-MG-1/2 and Eco. Group
- 200-BP-5 Group and 200-PO-1
- 200-SC-1 Group and 200-LW-1/2 Group
- 200-TW-1 and 200-PW-5
- 200-TW-2 Group
- 200-UR-1
- Recap Agreements, Issues and Action Items

200 Area Project Managers' Status Meeting
July 16, 2008

Please print clearly and use black ink

PRINTED NAME	ORGANIZATION	O.U. ROLE	TELEPHONE
Janice D. Williams	S+GRP-FH	M.C.	372 3553
Glen C Trainer	S+GRP-FH	200-UW-1 200-UP-1	430-1013
Frank Roddy	DOE/RL	200 Project	372-0945
MARCO VODAS	DOE/RL	200 Project	376-8375
Jenne Seaver	FH	D&D	376-3762
J. CAMMANN	FFS	200-SW-2	376-2037
BRIAN ESPARZA	FGG	200-TW-1 200-TW-2	376-6199
Tom Watson	FH	C. Plateau	376-5450
Jennifer Ollen	ECY	200 SW 1/2 FHW1	2-7988
Mark Byrnes	FH	2P-1 PM	373-3996
Phil Rogers	FH	NW-1/PJ-24	376-5807
GLORIA COMMINS	FH	PO-1 OU	372-2484
Greg Thomas	FH	BP-5 on	373-3907
Russ Hudson	FH	—	376-0303
John Decker	FH	SC- LW-1/2	376-4416
John Decker	FH	ECO	2-2426
Chris Wollam	FH	UR-1	373-1587
Arline Tub	DOE	200-Area PH	373-9631
RD Heibel	DOE	200 Area	373-9626
MIKE HICKEY	FH	CW-5 IS-1	373,3092

**200 Area Project Managers' Meeting
Agreements and Issues List
July 16, 2008**

Agreement: TPA-CN-226 for SGW-37320, Revision 0, Waste Control Plan for the 200-PW-2/4 Operable Unit: Add one direct-push borehole to be installed in the 216-S-1/2 crib in the 200-PW-2/4 Operable Unit (**Attachment 12**).

Issue: Ecology and RL do not agree on the pathforward for regulatory decisions on CS-1.

Delegations for July 16, 2008 UMM meeting:

EPA	Craig Cameron
Ecology	John Price
DOE/RL	Arlene Tortoso
	Larry Romine

OPEN ACTION ITEM TRACKING

Action #	Action/Subject	Assigned To	Owed To	Assigned Date	Original Due Date	Adjusted Due Date	Status
NO ACTIONS							

CERCLA 5-Year Review Action Items

Action #	Action/Subject	Assigned To	Due Date	Status
13-1	Complete a data quality objective process and sampling plan to further characterize the technetium-99 groundwater plume near T Tank Farm.	Fluor Hanford		Complete
14-1	Assess treatment options to address technetium-99 near T Tank Farm.	Fluor Hanford		Complete
15-1	Complete data quality objective process and sampling plan to further characterize the high soil conductivity measurements detected at B/C cribs and trenches.	sc		Complete
16-1	Increase the pump size in 200-ZP-1 extraction wells 299-W15-45 and 299-W15-47.	Fluor Hanford		Complete
17-1	Evaluate expanding the soil-vapor extraction operations. Also, specifically review converting former groundwater extraction well 299-W15-32 to a soil-vapor extraction well.	Fluor Hanford		Complete
18-1	Prepare an explanation of significant difference for 200-UP-1 Interim ROD	Ecology	6/1/2008	Second draft submitted by Ecology to DOE on 6/4/08.

S&GRP TPA Primary and Secondary Document Tracking List										
Document Data				Status of Document						
Operable Unit/Project	Document Title	Document Owner	Document Type - Primary or Secondary	Submitted to	Date Submitted	Date Anticipated to be Submitted	Response Due Date	Date Response is Received	Date Response is Voted On	Comments
200-CS-1	Feasibility Study and Proposed Plan, Draft B	Ron Brunke	P	EPA	06/11/07	NA	EPA		08/24/07	Final response to permit for TPA, Section II
200-CS-1	RCRA Closure Plans for 216-A-29, 216-B-63, and 216-S10 P/D	Ron Brunke	P	EPA	10/22/06	NA	EPA		12/21/07	Final response to permit for TPA, Section II
200-CW-5	Feasibility Study and Proposed Plan, Draft B	Mike Hickey	P	EPA		7/31/2005	EPA		TBD	
200-PW-1/3/6	DOE/RL-2007-27, Draft B, Feasibility Study for the Plutonium/Organic-Rich Process Condensate/Process Waste Group Operable Unit	Kathy Davis	P	EPA	NA	7/27/2005	EPA		TBD	Working on finalizing Draft B
200-PW-1/3/6	DOE/RL-2007-40, Draft B, Proposed Plan for 200-PW-1, 200-PW-3, and 200-PW-6 Operable Units	Kathy Davis	P	EPA	NA	12/22/2005	EPA		TBD	Working on finalizing Draft B
200-LW-1	Waste Control Plan	Jay Decker	S	EPA		4/15/2008	EPA		05/08/2008	
200-MW-1	Remedial Investigation, Rev. 0	Phil Rogers	P	RL to EPA	NA	7/20/2006	RL to EPA		TBD	The RI is being submitted to RL and they will then forward it to EPA for review.
200-MW-1	Remedial Investigation Report for Supplemental Investigations (representative title)	Phil Rogers	P	EPA	NA	4/17/2005	EPA	NA	10/15/2008	Final RI report submitted to EPA for review and approval.
200-SW-1/2	RIFS Work Plan, Rev. 0 with Redlines	Greg Berlin	P	RL to Ecology		7/25/2008	Ecology		8/29/2008	RL to submit the RI Work Plan Redlines to Ecology for approval.
200-TW-2	Waste Control Plan	Bill Barrett	S	Ecology	7/11/2008	NA	Ecology		8/25/2008	
200-MG-1/2	EECA for MG-1 and for MG-2	Roy Bauer	P	EPA and Ecology		12/31/2008	EPA and Ecology		TBD	
200-BP-5	Sample Analysis Plan for Groundwater Monitoring for BP-5, Rev. 2	Greg Thomas	P	RL and copy to EPA		9/30/2008	RL (to EPA)		TBD	On hold pending completion of DQG and Work Plan.
200-BP-5	RIFS Work Plan/SAP, DOE/RL-2007-18 Rev.1	Greg Thomas	P	EPA		8/18/2008	EPA		8/15/2008	Final RI report submitted to EPA for review and approval.
200-BP-5	DQG WMP-28945, Rev. 1	Greg Thomas	S	RL and copy to EPA		10/15/2008	RL (to EPA)	9/23/2008	8/29/2008	The report to be submitted to EPA for review and approval. The report to be submitted to EPA for review and approval. The report to be submitted to EPA for review and approval.
200-ZP-1	Feasibility Study, Rev. 0	Mark Byrnes	P	EPA	NA	NA	EPA	7/11/2008	NA	Final Rev. 0 to be issued by 7/21/08
200-ZP-1	Proposed Plan, Rev. 0	Mark Byrnes	P	EPA	NA	NA	EPA	7/11/2008	NA	Final Rev. 0 to be issued by 7/21/08
200-ZP-1	Purofite Resin Treatability Test Report	Mark Byrnes	S	RL and copy to EPA	9/7/2008	NA	RL and EPA	5/22/2008	NA	Document was issued by 7/11/08
200-ZP-1	Annual ZP-1 Pump and Treat System Performance Report, Rev. 0	Mark Byrnes	S	RL and EPA	NA	NA	RL and EPA	NA	NA	Document was issued by 7/11/08
200-PW-1 (formerly ZP-2)	Annual Soil Vapor Extraction System Performance Report	Mark Byrnes	S	RL and EPA	NA	7/31/2008	RL and EPA		8/15/2008	Will be issued by RL to EPA review by 7/31/08

200 AREA PROJECT MANAGERS' MEETING OPERABLE UNITS AND FACILITIES STATUS

July 16, 2008

D&D OUs

200-CW-3 - EPA Lead

- Remaining Sites SAP: scheduled to be transmitted for regulator review/approval in August.
- Remaining Sites RAWP: scheduled to be transmitted for regulator review/approval in August.

Rail Car Disposition Options Study

The railroad car disposition options study will be transmitted to regulatory agencies in early FY09. Then DOE will discuss options with the agencies.

EE/CA for Buildings 212-N, P, R – targeted to be transmitted to Regulators in September.

Schedule Status: On schedule.

200-BC Control Area (BCCA) – Ecology Lead

- The RAWP was approved by Ecology and DOE-RL on July 2, 2008.
- The Cultural/Historical assessment for Zone A of the BCCA completed the 30 day public comment review period on June 27, 2008. There were no additional comments.
- Mobilization activities specific to the BCCA excavation have begun, to include delivery of gravel and preparation for establishing the survey station to be used for closing and surveying the ERDF waste containers.

Schedule Status: On schedule.

200-UW-1 Ecology

- Final DOE/RL comments on the revised technical basis documents that describe how the STOMP modeling approach being proposed satisfies the applicable or relevant and appropriate requirements of WAC 173-340-747(8) and other State and Federal regulations and guidance were provided to FH on July 3, 2008. Incorporation of the comments will be completed by July 18, 2008.
- The U-1/2, U-12, and 270-W Supplemental Deep Vadose Zone characterization DQO has been slipped to August due to scheduling conflicts.
- DOE/RL has received and is reviewing a draft schedule supporting the issuance of a final ROD next FY.

Schedule Status: DOE: On schedule.

FACILITIES STATUS

- DOE received Regulator comments on the 221-U RD/RAWP and initiated the TPA dispute processes to resolve comments. All topics (5) resolved at June IAMIT. RD/RAWP being revised per dispute resolution and scheduled to be transmitted for regulator review/approval in September 2008.
- U Plant Ancillary Facilities Removal Action Work Plan is in revision per 221-U RD/RAWP dispute resolution; scheduled to be transmitted for regulator review/approval in August 2008.

Central Plateau Facility Decommissioning

- The Agreement in Principle for decommissioning central plateau facilities is in approval process.

Schedule Status: 221-U RD/RAWP is behind schedule. There is no formal schedule for the Facility Decommissioning AIP.

200-UP-1, 200-CS-1, 200-CW-1 OU Group

200-UP-1

- Values at well 299-W19-36 dropped below the 9,000 pCi/L RAO for Technetium-99. Well 299-W19-36 yielded a concentration of 7,400 pCi/L in a January 8, 2008 sample based on interim results.
- All other wells are below the interim RAOs of 480 µg/L and 9,000 pCi/L respectively (**Attachments 6 and 7**).
- RI/FS Work Plan:
 - Monitoring continues.
- Explanation of Significant Difference (ESD):
 - Ecology transmitted the draft ESD to DOE/RL and EPA for review. A second Revision was received on June 4, 2008. A meeting was held on June 23, 2008 between DOE/RL and Ecology to discuss the document. DOE/RL is current awaiting receipt of a third revision incorporating agreements reached in the meeting.
- Pump and Treat
 - Through July 2, 2008 the 200-UP-1 Pump and Treat System has extracted approximately 5.5 million liters of groundwater. The ETF has treated an estimated 3.91 million liters between October and December 2007. During treatment, the ETF removed an estimated 1.48 kg of Uranium, 18.2 gm of Tc-99, 476 kg of nitrate and 250 gm of carbon tetrachloride from the 200-UP-1 wastewater.
 - On April 16, 2008 well 299-W19-43 pump failed and went off-line. The pump has been replaced; however a faulty conductivity switch was identified during pump testing. The switch is expected to be replaced in the next three weeks.

Schedule Status: On schedule.

200-CS-1

- RL received a letter from Ecology dated June 13, 2008, *200-CS-1 and 200-UW-1 Operable Units(OU), Department of Ecology Priorities for Federal Fiscal Year (FFY) 2009 Budget*. This letter requests RL to not use FFY 2009 funding for a 200-CS-1 FS or PP, rather to use funding for a CERCLA Action Memorandum and provide funding for closure plan updates. Ecology stated that they expect a response from RL to this letter.
- Ecology/RL discussions to reach agreement on specific clean-up actions and clean-up levels are continuing.

Schedule Status: Behind schedule according to DOE baseline.

200-CW-1

(M-015-38B, 5/31/09, Feasibility Study/Proposed Plan) Ecology

- The Class II Change Request Number M-15-08-02 was approved on May 29, 2008. The Change Request moves the date for submittal of the FS and PP to November 30, 2010.

Supplemental Remedial Investigation

- The 216-T-4B Pond slim line DPTs will occur in late July (interface with Tank Farms).
- Logging of the 33 slim line DPTs is completed and the results will be analyzed as soon as the logging from the 100 foot slim line DPTs is completed and the associated soil sampling depths are approved. Next the related soil sample locations and depths associated with the 33 logged holes will be proposed for approval.
- The 100' direct pushes are completed and logged and analyzed. The associated soil sample depths for three have been approved and for four proposed. The holes are being decommissioned after the soil sampling depths have been approved, and the direct pushes for soil samples will follow.
- The 216-U-10 borehole is completed and decommissioned. The soil samples analysis follows.
- The Test Pits (Augers) in U Pond are now scheduled to begin in late July.

Schedule Status: On schedule.

200-BC-1, 200-IS-1, 200-CW-5, & 200-SW-1/2 OU Group

200-BC-1

(M-15-51, 4/30/10, Feasibility Study/Proposed Plan) EPA

- Completed drilling and sampling the last of the three boreholes for electrical resistivity characterization (ERC) correlation planned this FY. Continued lab analyses of contaminant concentrations and soil properties and preparation of draft report evaluating the correlation of data.
- Phase 2 of the Excavation-based Treatability Test continued in the more highly contaminated middle section of the 216-B-26 Trench. Excavation of soil from this 1/3 of the trench and loading of containers for disposal at ERDF is about 80% complete and expected to finish the week of July 14, 2008.

Schedule Status: On schedule.

200-IS-1

(M-13-27, 6/30/07, RI/FS Work Plan) Ecology

- Field work started the last week in June 2008. Direct pushes for pipelines 200-E-192-PL 1&2, 200-E-188-PL, 200-E-160-PL, and 200-E-127-PL are complete.
- Geophysical logging started the first week in July 2008. Geophysical logging is complete for pipelines 200-E-192-PL 1&2. The raw data is being processed.

Schedule Status: Three weeks behind this FY field schedule.

200-CW-5 (no change)

(M-15-40D, 7/31/08, Feasibility Study/Proposed Plan) EPA

Feasibility Study and Proposed Plan are on schedule for submittal July 31, 2008.

Schedule Status: On schedule.

200-SW-1/2

(M-15-00, 12/31/11, Feasibility Study/Proposed Plan) Ecology

- Completed TPA milestone M-13-28 (Transmit RI/FS Work Plan (Draft B) to Ecology by September 30, 2007) on schedule.
 - Completed RI/FS Work Plan (Draft B) comment resolution meetings with RL and Ecology. All comments (266 total) resolved.
 - Proceeding with comment incorporation, Work Plan (Rev 0).

Schedule Status: On schedule.

200-ZP-1, 200-PW-1/3/6 OU Group

200-ZP-1

(M-15-48B, 9/30/07, Feasibility Study/Proposed Plan) EPA

- Remediation Treatment Status:
 - Between October 1, 2007 and June 1, 2008 the 200-ZP-1 pump-and-treat

- system average pumping rate was approximately 234 gpm.
- All ten 200-ZP-1 extraction wells are currently off line as we are currently working on connecting the four new extraction wells to the ZP-1 treatment system.
 - The transfer lines have been laid.
 - The screens and pumps have been installed into the wells.
 - The PLC has been installed.
 - Some preliminary testing of water from the extraction wells will be started soon.
 - Aquifer testing in the vicinity of T Tank Farm is now complete. Both extraction wells W11-45 and W11-46 were offline last week to allow an ERDF leachate transfer, but are now both back on line pumping around 47 gpm.
 - **Attachment 8** shows the latest carbon tetrachloride concentrations in extraction well 299-W15-6.
 - Tc-99 concentrations have been increasing again in extraction well 299-W15-765. The ZP-1 treatment water is now at approximately 60% of the MCL.
- RI/FS Status:
 - FS and PP Report:
 - Rev. 0 reports are currently being issued.
 - Tc-99 Investigation Status:
 - T Tank Farm Investigations:
 - The new "T-6" (W11-89) well will be staked in early September 2008 once the results from the aquifer testing have been evaluated by an FH sub-contractor.
 - Purolite Resin Treatability Testing:
 - Purolite Resin Treatability Test Report (DOE/RL-2008-25) has been issued.

Schedule Status: On schedule.

200-PW-1, 200-PW-3, & 200-PW-6

(M-15-45B, 9/30/07, Feasibility Study/Proposed Plan) EPA

- The plan and schedule for Draft B of the FS and PP were developed and transmitted to RL. RL is in the process of transmitting the plan and schedule to EPA. Work is in progress on preparation of these documents.
- Soil Vapor Extraction System (SVE):
 - The SVE system is still situated at Z-1A.
 - Between April 1 and June 1, 2008, the soil vapor extraction system average pumping rate was 365 cfm.
 - The vendor bid for two new 500 cfm systems has been accepted, but has been extended to November 2008.

- Monthly monitoring results for June 2008 for the three narrow diameter wells south of 216-Z-9 are shown in **Attachment 9**. Monthly monitoring results for June 2008 at the other soil vapor probes and wells were consistent with results from previous monitoring.

Schedule Status: On schedule.

200-MW-1 & PW-2 OU Group

200-MW-1

(M-15-44B, 12/31/08, Feasibility Study/Proposed Plan) EPA

- The mini-RI for the supplemental investigations has been reviewed internally and comments are being incorporated.
- No action on the RI (DOE/RL-2005-62). EPA comments on the draft RI (DOE/RL-2005-62) were received May 2, 2008.
- Preparation of the FS report continues.
- The mini-DQO was kicked off June 10, 2008 and a second meeting held July 15, 2008.

Schedule Status: On schedule to meet TPA interim milestone.

200-PW-2 & 200-PW-4

(M-15-43D, 12/31/10, Feasibility Study and Revised Recommended Remedy(ies)) Ecology

- The planned deep borehole in the 216-A-5 Crib has been initiated and as of July 10, 2008 is at a depth of about 64 ft bgs.
- DOE and Ecology approved a change notice (Change number TPA-CN-226 - See Agreements and Issues) for the installation of a direct push near the S-2 crib box in the 216-S-1/2 Crib. A deep borehole is planned to penetrate the S-2 crib box, and the DP will provide information for health and safety and may also be used to refine the sample design associated with the deep borehole.
- The direct push at the 216-A-5 Crib was completed except for decommissioning.
- A direct push at the 216-S-1/2 has been advanced to 63 ft bgs and logged. Preliminary geophysical logs indicate higher than expected levels of Cs-137 which require the work at the 216-S-1/2 Crib be upgraded to "high-risk". This DP (C5554) will be advanced to refusal and relogged. If Cs-137 activity is still elevated then the planned sediment sample may be eliminated provided a TPA change notice is approved.

Schedule Status: On schedule to meet TPA interim milestone.

200-MG-1/2 & ECO OU Group

200-MG-1/200-MG-2 Model Group 1 Sites (no change)

(M-15-49A, 12/31/08, MG-1 EE/CA) Ecology

(M-15-49B, 12/31/08, MG-2 EE/CA) EPA

The M-15-49A and M-15-49B Milestones require engineering evaluations/cost analyses (EE/CAs) by December 2008. Work continues to prepare the EE/CAs.

Schedule Status: On schedule to meet the TPA interim milestones.

Ecological Risk Assessment (no change)

- EPA submitted their comments on the Rev A Central Plateau Ecological Risk Assessment (ERA) on April 30, 2008. Comments were received from the Yakama Nation on May 5, 2008. Ecology's comments were received on May 20, 2008.
- Responses are being developed for the decision-maker comments on the Rev A ERA.

Schedule Status: Currently 2 months behind the DOE baseline.

200-BP-5 & PO-1 OU Group

200-BP-5

(M-13-06B, 3/31/07, RI/FS Work Plan, Completed) EPA

(M-15-21A, 10/31/10, Feasibility Study/Proposed Plan) EPA

Drilling:

- Drilling of well 299-E33-205/C5989 began April 30, 2008. Drilling as of COB July 10 had advanced to 262.5' bgs. Drilling advanced 93' this past month. No contamination was found in the vadose zone. The groundwater was encountered at 259.5' bgs.
- Drilling of well 299-E33-340/C5853 began April 7, 2008 (Figure 2, **Attachment 10**). The Rattlesnake Interbed was encountered at 302' bgs on June 13, 2008. Drilling as of COB July 10 had advanced to 341' bgs. Gross beta results are showing slightly elevated readings (22-23 pCi/g versus <10 pCi/g).
- Drilling of well 699-52-55B/C5862 began June 12, 2008 (Figure 3, **Attachment 11**). The Rattlesnake Interbed was encountered at 222' bgs on June 27, 2008. Drilling as of COB July 10, 2008 had advanced to 228.3' bgs.

Slug Tests:

- Well 699-52-55 Slug test report is planned to be released by PNNL this week. The test results indicate very low hydraulic conductivity in the unconfined aquifer at this well (Figure 3).

Depth Discrete Sampling

- The depth discrete sampling SOW is being issued to PNNL this week. The sampling is targeted in 16 wells for a total of 66 samples. The majority of the wells are around the B/BX/BY and C WMAs, two wells north of 200 East Area, and one well south of LLWMA II. The sampling results are anticipated to refine inventory levels and the conceptual transport model.

Treatability Test Planning

- Currently developing an estimate for a treatability test for the WMA B/BX/BY.

200-BP-5 DQO Revision (WMP-28945 Rev 1):

Revision associated with Work Plan comments. Revision is focused on providing more detailed conceptual models and relating the conceptual models to the well placement locations. Areas identified for revision were the following:

- Section 1.4.3 and associated Appendix C: The revision has been completed. Awaiting comments from EPA.
- Section 1.4.4 and associated Appendix D: The revision is approximately 90% complete and includes additional discussion and figures showing contaminant plumes to clarify transport and plume extent.
- Revision to DQO Section 1.10 and 7 will be completed next.

Meetings are being planned with EPA for review and comment after drafts have been completed. Reviewers will include FH, PNNL, CHG and DOE.

Integration:

Reviewing CHG Single-Shell Tank Phase II Master Work Plan.

Drilling well 299-E33-205/C5989 with CHG support.

PNNL analytical analysis support for samples collected for remedial investigation.

Review by PNNL and CHG of drafted revisions of the 200-BP-5 RI/FS DQO.

Schedule Status: Behind schedule. The drilling schedule has slipped 3+ months due to delayed start this year, development of unplanned perched well, and completion problems for well 299-E33-345.

200-PO-1

(M-015-25C, 12/30/09 200-PO-1 OU RI Phase II Report) Ecology

- Phase I and II Airborne EM field work for the 600 Area lying east and south of the 200 E Area was completed on June 20, 2008.
- A second flyover using a different EM device capable of high resolution to a shallower depth was completed July 3, 2008.
- Groundwater samples were taken at the BC-Cribs "A" Borehole. Analytical results are not yet available.

Schedule Status: On schedule to meet M-015-25C.

200-SC-1 & 200-LW-1 OU Group

200-SC-1

(M-15-40E, 12/31/10, Feasibility Study/Proposed Plan for 200-SC-1) EPA

- Preparing borehole summary reports and collecting and reviewing analytical characterization data from laboratories.

Schedule Status: On schedule.

200-LW-1/200-LW-2

(M-15-46B, 12/31/11, Feasibility Study/Recommended Remedy) Ecology

- Preparing a waste control plan and internal supplemental characterization planning documents.

Schedule Status: On schedule.

200-TW-1 & 200-PW-5 OU Group

200-TW-1 & 200-PW-5

(M-15-42D, 12/31/11, Feasibility Study/Proposed Plan for TW-1 & PW-5) EPA

- Field work scheduled to start late July or early August 2008 at 216-S-13 borehole.

Schedule Status: On schedule.

200-TW-2 OU Group

200-TW-2

(M-15-42E, 12/31/11, Feasibility Study/Revised Recommended Remedy(ies) for TW-2) Ecology

- Waste Control Plan (SGW-37530) draft has been submitted to DOE and Ecology. Comments received from DOE on June 24, 2008, awaiting Ecology comments on informal draft.

Schedule Status: On schedule.

200-UR-1

200-UR-1 Ecology

- BC Control Area
 - Issued SOW for remaining BCCA tasks.
 - Contractor will compile a report integrating all data related to BCCA characterization [MARSSIM Step: Characterization Survey].
 - Contractor will develop MARSSIM radiological counting statistics (Survey Readings based on Cs-137 as Surrogate) to be used by Hanford Radiation Control Technicians during closure surveys [MARSSIM Step: Final Status survey].
 - Contractor will develop MARSSIM radiological counting statistics for “Hot Spots” [MARSSIM Step: Final Status Survey].

- West Lake
 - SAP being drafted.
- Other UR-1
 - Reclassification Forms for revising 12 sites from “No Action” to “Rejected,” submitted to DOE June 26, 2008.

Schedule Status: West Lake DQO and SAP twelve months behind DOE baseline.

200-UP-1, Uranium ($\mu\text{g/L}$)

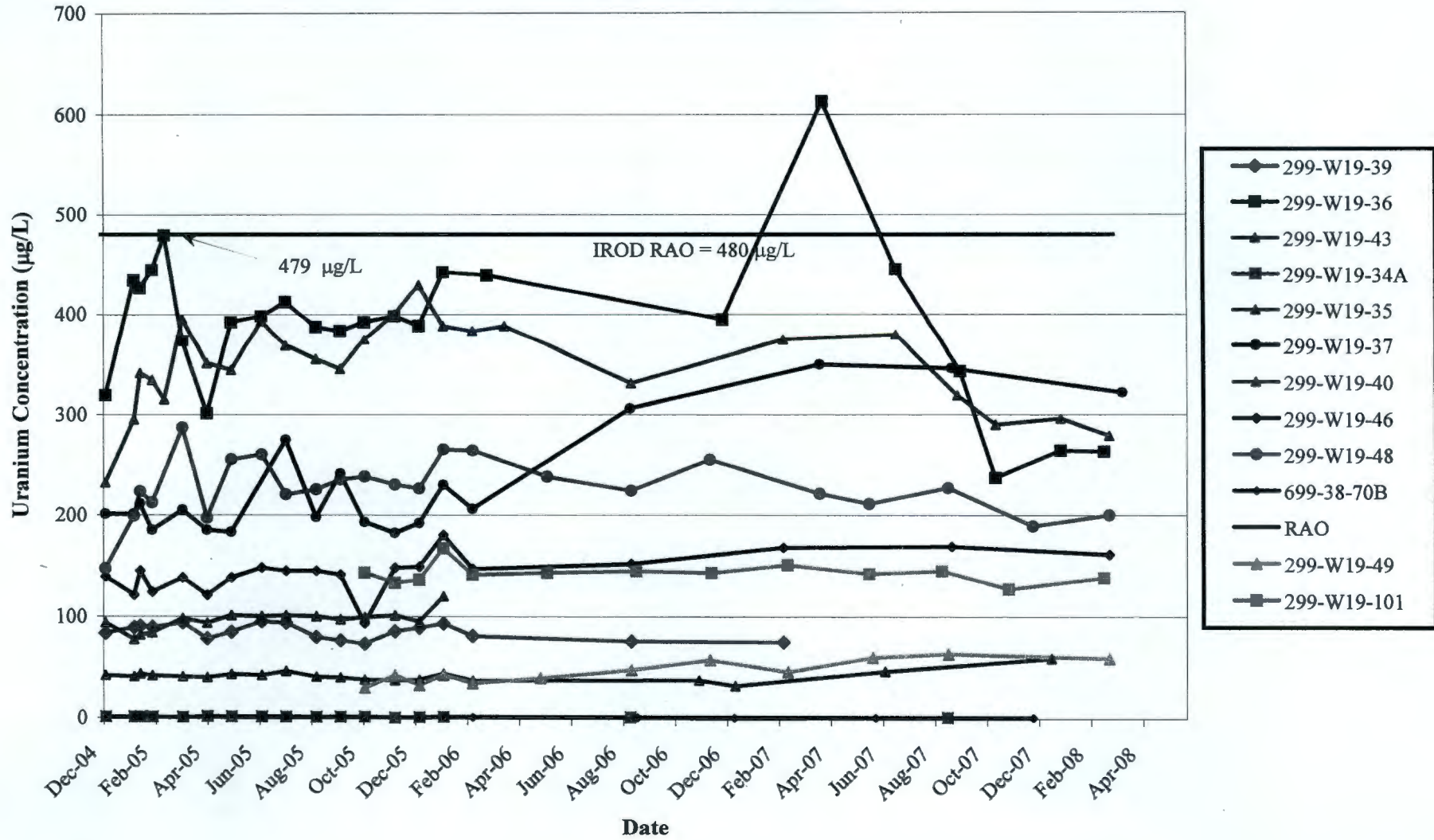

200-UP-1, Technetium-99 (rCi/L)

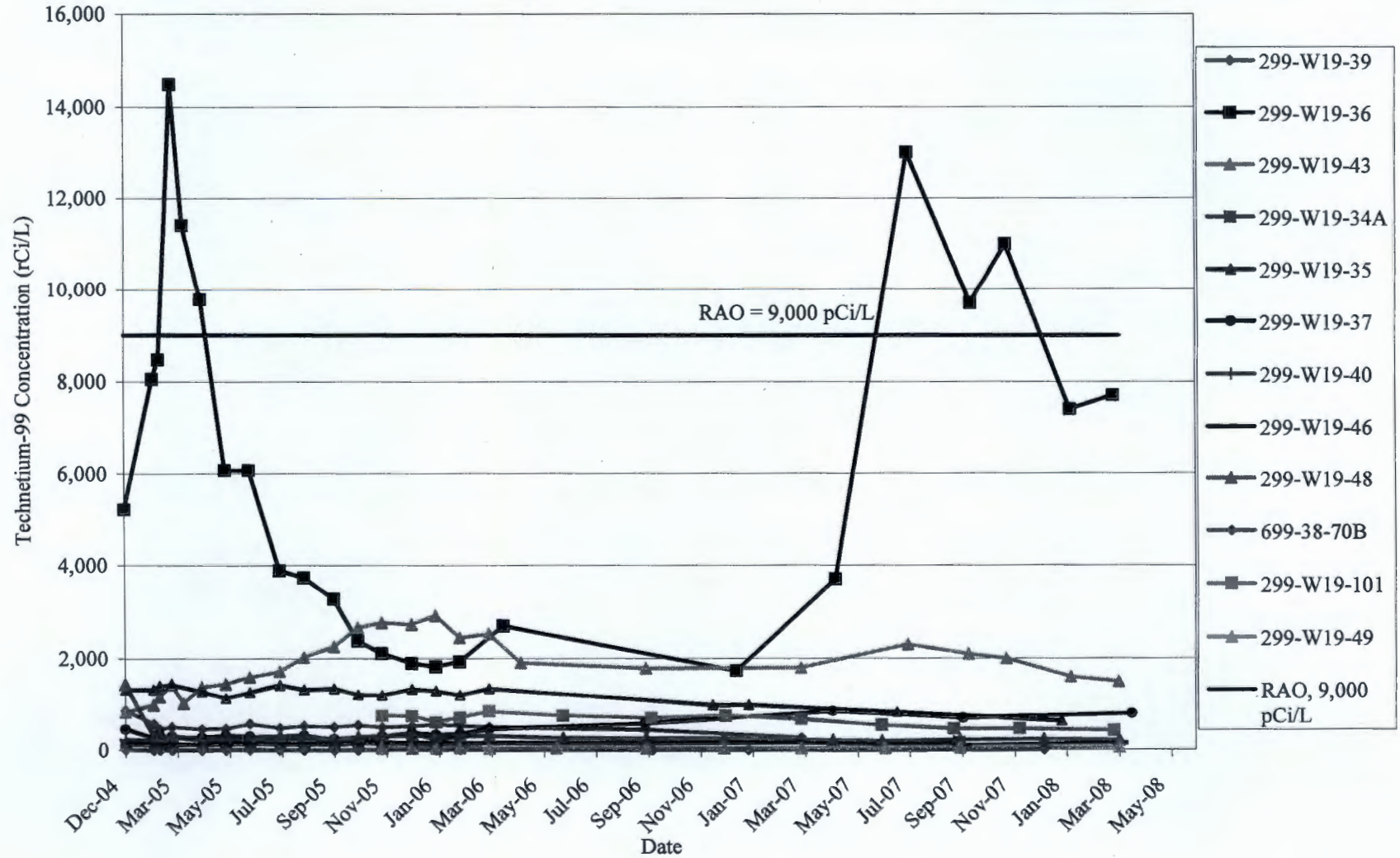

200-PW-1 OU: 3 Narrow Diameter Vapor Extraction Wells

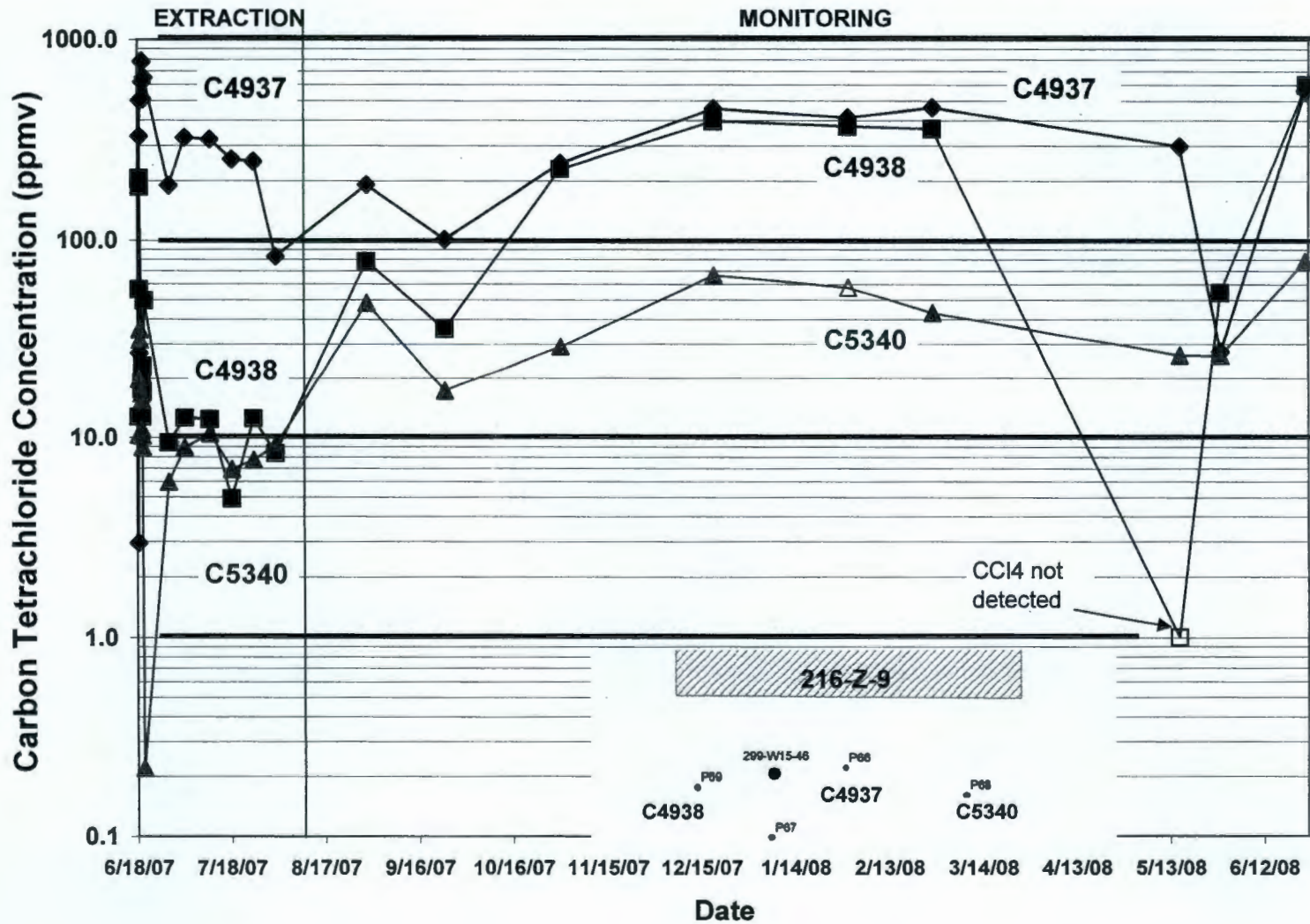

Figure 2: Wells 299-E33-340 Location Map.

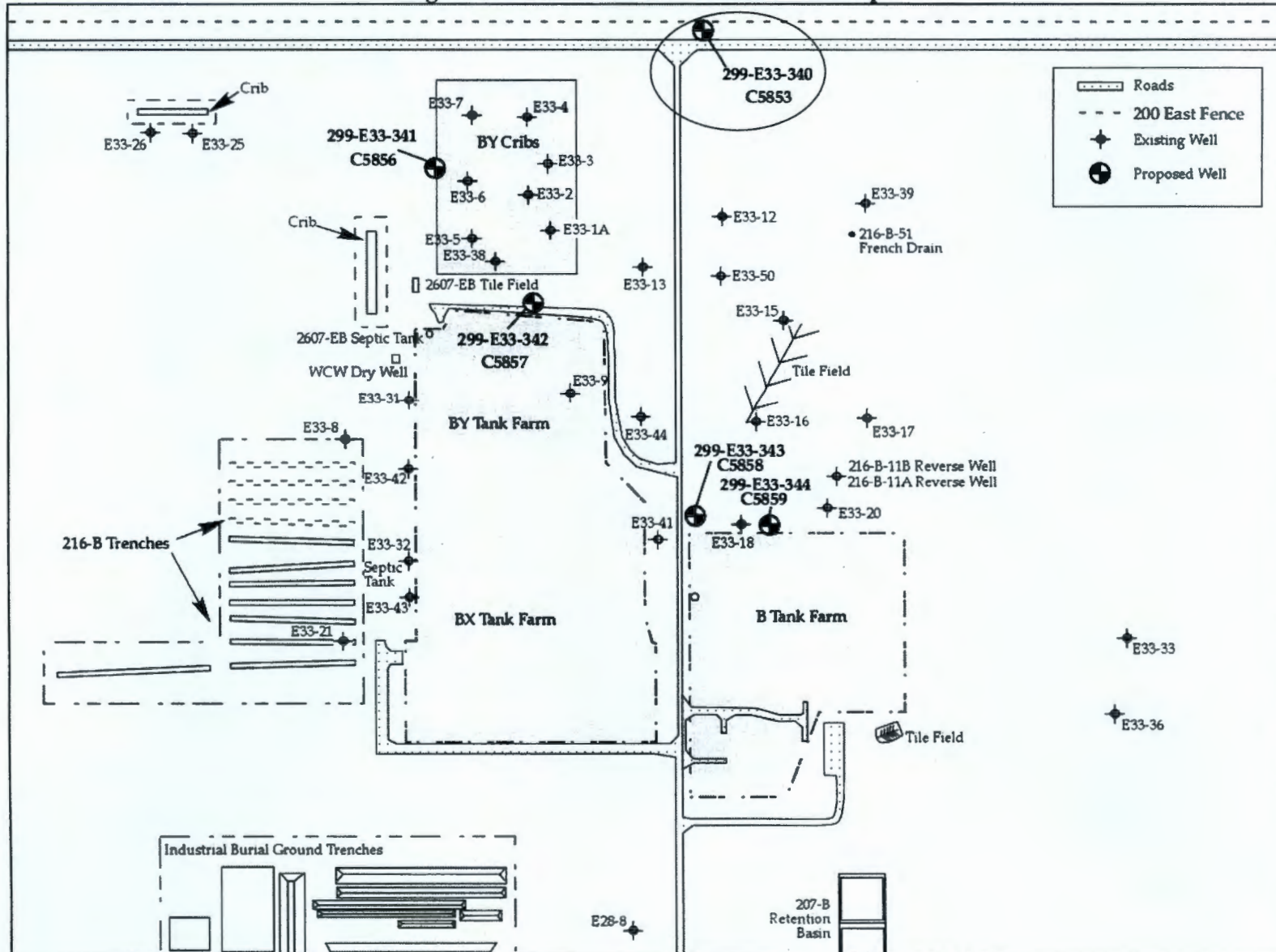
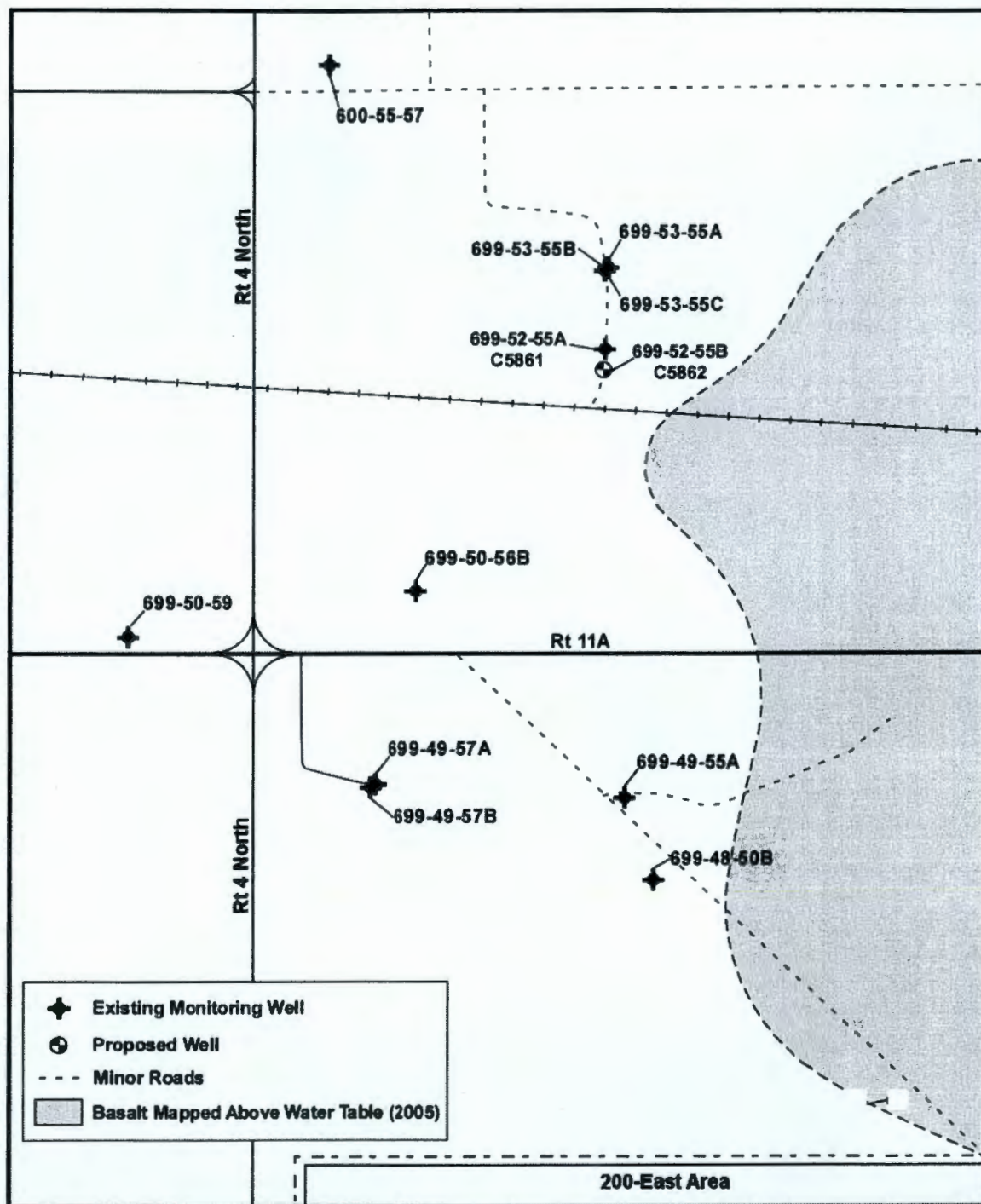

Figure 3: Well 699-52-55 Location Map.





Attachment 12, Figure 1

Change Notice for Modifying Approved Documents/ Workplans
 In Accordance with the Tri-Party Agreement Action Plan,
 Section 9.0, Documentation and Records

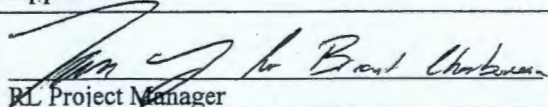
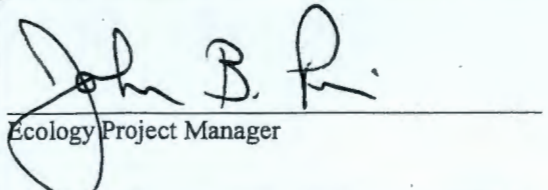
Change Number	Document Submitted Under Tri-Party Agreement Milestone	Date:	
TPA-CN-226	N/A	06/___/2008	
Document Number and Title: SGW-37320, Revision 0, Waste Control Plan for the 200-PW-2/4 Operable Unit		Date Document Last Issued: April 2008	
Originator: Phil Rogers		Phone: 376-5807	
Description of Change: Add one direct-push borehole to be installed in the 216-S-1/2 crib in the 200-PW-2/4 Operable Unit.			
<p><u>B. L. Charboneau</u> and <u>J. B. Price</u> agree that the proposed change modifies an approved RL Lead Regulatory Agency workplan/document and will be processed in accordance with the Tri-Party Agreement Action Plan, Section 9.0, <i>Documentation and Records</i>, and not Chapter 12.0, <i>Changes to the Agreement</i>.</p> <p>One direct-push borehole (C6835) is added to Table A-2, 200-PW-2/4 Operable Unit Well List. The purpose of the direct-push borehole is to obtain geophysical data to assist in planning for the deep borehole (C6555). The direct-push (C6835) will be located adjacent to the deep borehole (C6555). Revised Table A-2 is attached with the change identified in gray highlight. A location plat is also attached.</p>			
Justification and Impacts of Change:			
Due to high radiological conditions in 216-S-1/2 crib, an additional direct-push is needed to assist in planning for the proposed deep borehole.			
ROK 6-25-08			
Approvals:			
 RL Project Manager	<u>6/25/08</u> Date	<input checked="" type="checkbox"/> Approved	<input type="checkbox"/> Disapproved
 Ecology Project Manager	<u>6-25-2008</u> Date	<input checked="" type="checkbox"/> Approved	<input type="checkbox"/> Disapproved
	_____ Date	<input type="checkbox"/> Approved	<input type="checkbox"/> Disapproved

Attachment 12, Figure 2

Table A-2. 200-PW-2/4 Operable Unit Well List
(1 sheet)

200-PW-2 Wells			
299-E17-001	299-E17-051	299-E25-181	299-W22-045
299-E17-009	299-E24-016	299-E28-009	299-W22-079
299-E17-014	299-E24-017	299-E28-076	C6551*
299-E17-015	299-E24-058	299-W19-018	C6552*
299-E17-016	299-E24-059	299-W19-034A	C6553*
299-E17-017	299-E24-060	299-W19-034B	C6554*
299-E17-018	299-E24-160	299-W22-003	C6555*
299-E17-019	299-E25-002	299-W22-010	C6835*
299-E17-020	299-E25-010	299-W22-043	
200-PW-4 Wells			
299-E17-013	299-E25-018	299-W19-006	299-W19-089
299-E17-053	299-E25-019	299-W19-020	
299-E17-054	299-E25-020	299-W19-039	
299-E25-017	299-E27-005	299-W19-040	
* new wells to be drilled and decommissioned in association with the work described in this waste control plan			

Attachment 12, Figure 3

Location Plat for 216-S-1/2 Crib Direct-Pushes and Boreholes

